



BHARAT HEAVY ELECTRICALS LIMITED

(A Government of India Undertaking)
HIGH PRESSURE BOILER PLANT
PURCHASE DEPARTMENT - FOSSIL BOILERS
THIRUCHIRAPALLI - 620014
TAMILNADU (INDIA)

Page
1/2

PHONE :0431-2577938
GRAMS : BHARATELEC
FAX NO: 0431-2520719
E-mail: tvenkat@bheltry.co.in
Web:

Enquiry No	Enquiry Date	Due Date for Quotation
2661700477 - 55	28.07.2017	22.08.2017
Please quote Enquiry No, Date and due date in all correspondences. This is only a request for quotation and not an order. Bid should be submitted in two parts. 1.Techno-commercial bid (Part-I) and 2.Price bid(Part-II) in a separate sealed cover and both covers must be placed in a third cover and sealed. Our Enquiry No., Enq. date & Enq. Due date must be written on all three covers.		

Item	Description	Unit	Quantity	Delivery Quantity	Schedule Date
10	7520B0707100 PISTON CUP 4M-20B-07-2760 <H>VENDOR QUALIFYING CRITERIA:</> (1) Only those vendors, who have Supplied Lether items within past seven years from the date of tender opening are eligible to participate in tender for which order copy is to be submitted along with the offer. (2) BHEL may verify the information provided by vendor. In case the information provided by vendor is found to be false/ incorrect,the offer shall be rejected. <H>TECHNICAL SPECIFICATION:</> PISTON CUP AS PER DRG. No. 4M-20B-07-2760 <H>NOTE FOR ITEM 10 AND 20:</> (1) Working media of piston cups is soft water. (2) Working Pressure is 2 Kg/cm2. (3) After placement of purchase order,Five Number of samples in each items has to be supplied for BHEL acceptance preferably within 4 weeks from date of purchase order. After acceptance of samples only balance quantity to be supplied.Acceptence by BHEL will be given within 1 week on receipt of samples. (4) Preferable Delivery period is to be Within 3 months from the date of purchase order.	NO	75.000	75.00	30.03.18
20	7520B0707300 PISTON CUP 4M-20B-07-2706 PISTON CUP AS PER DRG. No. 4M-20B-07-2706.	NO	75.000	75.00	30.03.18

General Note:

GENERAL NOTE:

PLEASE SUBMIT YOUR OFFER IN TWO PART BID SYSTEM

All the tenders may be addressed to the following address:

**The Tender Opening Cell / MM
Room No: 26, Building 24, Ground Floor**

The offers should reach us 30 minutes before the time of opening of tenders.
The offers will be opened at 14.30 hrs on the due date of tender in the presence of tenderers who have submitted their offer and who may like to be present for the tender opening.Late and delayed offers are liable to be rejected.

Yours faithfully,
For BHARAT HEAVY ELECTRICALS LIMITED

V. CHELLIAH
MANAGER / PURCHASE
Sr Manager, Purchase
(FOSSIL BOILERS)
MM / RM / CP & SP
Yours faithfully,
BHEL, TRICHY - 620 014.



BHARAT HEAVY ELECTRICALS LIMITED

(A Government of India Undertaking)
HIGH PRESSURE BOILER PLANT
PURCHASE DEPARTMENT - FOSSIL BOILERS
THIRUCHIRAPALLI - 620014
TAMILNADU (INDIA)

Page
2/2

PHONE :0431-2577938
GRAMS : BHARATELEC
FAX NO: 0431-2520719
E-mail: tvenkat@bheltry.co.in
Web:

2661700477 / 28.07.2017

23505

**Bharat Heavy Electricals Limited
TIRUCHIRAPALLI 620014**

In case personal delivery of the offer, it shall be dropped into the respective box kept in Room No: 26, after duly entering the data in the system.

Offers will be accepted only up to 14.00 Hrs on the due date. Therefore, vendors shall ensure to submit the offers well before this time. All due date extension requirements should be addressed to the respective Purchase mail IDs. All the due date extension requests from vendors will be considered only up to 48 hours before the due date and time.

Vendors are requested to avoid submission of offers through e mail / fax. In case of any unavoidable situation, offers shall be sent through e mail to the following mail ID only tender_cell@bheltry.co.in.

As tenders are being opened by Common Tender Opening Cell, offer covers should be sealed with tenderer's distinctive seal and super scribed with correct Tender No. item of supply and due date of opening.

The offers will be opened at 14.30 hrs on the due date of the tender in the presence of tenderers who have submitted their offer and who may like to be present for the tender opening. Late and delayed offers are liable to be rejected.

The bidder along with its associate/ collaborators/ sub-contractors/ sub-vendors/ consultants/ service providers shall strictly adhere to BHEL fraud prevention policy displayed on BHEL website <http://www.bhel.com> and shall immediately bring to the notice of BHEL management about any fraud or suspected fraud as soon as it comes to their notice.

The supplier shall submit EI/EII forms to BHEL time to time as indicated by the BHEL and in case of inordinate delay in issuing EI/EII forms, then BHEL reserves the right to deduct 5% of the value of the supplied items against which EI/EII forms pending to be issued

Enclosures:

"LD clause has to be confirmed without fail."

The offers should reach us 30 minutes before the time of opening of tenders.
The offers will be opened at 14.30 hrs on the due date of tender in the presence of tenderers who have submitted their offer and who may like to be present for the tender opening. Late and delayed offers are liable to be rejected.

Yours faithfully,
For BHARAT HEAVY ELECTRICALS LIMITED

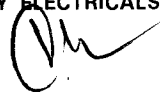
MANAGER / PURCHASE
(FOSSIL BOILERS)
Yours faithfully,

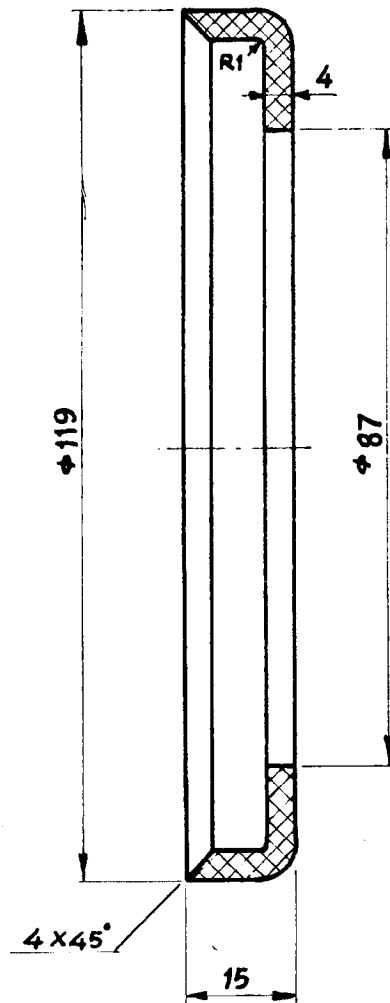

2			LEATHER					2-M-20&-0423	12
NO. OF PIECES	DESCRIPTION	SEMI PRODUCT	FINAL MATERIAL	INITIAL MATERIAL	SCRAP SORT	NET WT	GROSS WT	DRAWING NO.	ITEM NO.
REMARKS : Material according to MR 4				TOTAL NET wt (kg) CC 00 EL 00					
SCALE	DRAWN	REFERENCE		ALTERATIONS	DATE	SIGNA- TURE	ALTERATION INDEX		
1:1	CHECKED	9194							
	APPROVED								
	STDS. OFFICER								
	DATE	26.3.68							
		MACHINE : PRODUCER GAS PLANT		TYPE : 4513 : 01		INV. NO.			
		TITLE :		DRAWING NO :		07			
		PISTON CUP		4-M-20&-2760					
				NO. OF SHEETS		SHEET NO :			

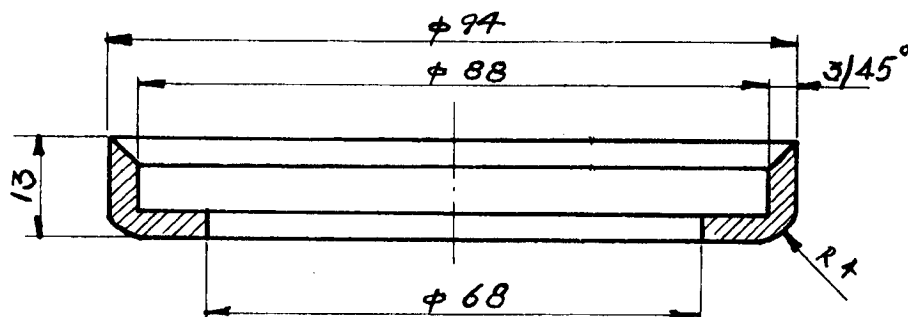

2			LEATHER			0,007	2-M-20B-0419	10
NO. OF PIECES	DESCRIPTION	SEMI PRODUCT	FINAL MATERIAL	INITIAL MATERIAL	SCRAP SORT	NET WT	GROSS WT	DRAWING NO. ITEM NO.
REMARKS : Material according to MR 4				TOTAL NET wt (kg) 22.16 Ec:07				
SCALE	DRAWN	REFERENCE		ALTERATIONS	DATE	SIGNA- TURE	ALTERATION INDEX	
1:1	CHECKED	MAKERS'						
	APPROVED	DRG N°						
	STDS. OFFICER	9207						
	DATE	6-3-1968						
		MACHINE : PRODUCER GAS PLANT		TYPE : 4513:01		INV. NO.		
		TITLE :		DRAWING NO :		07		
		PISTON CUP		4-M-20B-2706				
				NO. OF SHEETS		SHEET NO :		

Annexure for Techno Commercial Bid
Check List - to be filled and submitted along with Technical Bid

BHEL Commercial Terms and Conditions for Indigenous Supplies		Vendor's Confirmation / Comments
Technical confirmation to BHEL's Specification as called for in BHEL Format shall be furnished. If needed additional sheets shall be used.		
Prices shall be quoted item wise only as per the model format enclosed		
Prices shall be quoted on "FIRM PRICE" basis only The prices should be only on F.O.R / Despatching station basis with Packing & Forwarding charges if any. Applicable % of ED & Sales Tax, Freight & Insurance, Installation & Commissioning Charges should be clearly Indicated		
Validity of offer shall be for a minimum period of 120 days from the date of Tender opening		
Delivery period from the date of Letter of Intent / Purchase order shall be clearly mentioned in the offer		
Liquidated damages @ '0.5% per week subject to a maximum of 10% of the order value shall be applicable for delay in deliveries For Details Refer Annexure- v		
Following Risk Purchase clause shall be applicable The purchaser at his option will be entitled to terminate the contract and to purchase elsewhere at the risk and cost of the seller either the whole of the goods or any part which the supplier has failed to deliver or dispatch within the time stipulated or if the same were not available, the best and the nearest available substitute therefore The supplier shall be liable for any loss which the Purchaser may sustain by reason of such risk purchases		
Payment term for supply portion: Payment term is 100% direct payment after 45 days from the date of receipt and acceptance of materials For details Refer Annexure- v		
Erection / commissioning: (if applicable only) Erection / commissioning charges if any has been mentioned in the offer or else confirmation that Erection / commissioning shall be done at free of cost is available in the offer,		
The equipment shall be guaranteed for a period of 12 months from the date of commissioning		
Final inspection and acceptance of equipment will be after installation at BHEL, Trichy		
The vendor shall provide necessary drawings, Test Certificates and Operating Maintenance Manuals etc., as called for in the Technical Specification, in the required number of copies at no extra cost		
Any warranty replacement during warranty period shall be supplied free of charge on FOR BHEL, Trichy basis.		
% of Excise Duty with cess		
% of TAX (CST/VAT) (INGST with FORM-17 or CST with C-FORM)		
Packing & Forwarding Charges (if any in % only)		
Percentage of Freight& transit insurance charges, if any Freight charges from Dispatching station to BHEL, Tiruchirappalli • Supplier should quote for F.O.R-BHEL Trichy Stores.		
As per Commercial terms and conditions, acceptance for participation in Reverse auction (RA).Yes/No to be indicated		
Name of the person for participating reverse auction		
Land Line Number		
Fax Number		
Mobile Number		
E-mail ID		

NOTE:-

- a) It is confirmed that all the terms and conditions stipulated In the Enquiry have been fully understood by us and all clarifications & details have been obtained.
- b) Your offer should be indicating applicable If any P&F Charges, % of ED, Sales Tax -CST or VAT, Service Tax), Freight, Insurance and Installation and Commissioning Charges etc., as per our Price Format
- c) Your specific acceptance to our Payment terms, LD & Risk Purchase Clause are essential for consideration of your offer. Other wise your offer is liable for rejection.
- d) No row shall be left blank. Please indicate NA, in case the item is "not applicable"

Annexure for Price Bid

Bharat Heavy Electricals Limited TIRUCHIRAPPALLI
MODEL PRICE BID FORMAT FOR INDIAN BIDDERS

CAPITAL PURCHASE
Annexure-IV

Enquiry No. & Date:
Bidder's Offer No. & Date:

Sl No	Description of Item	Unit	Quantity	Rate in Rs.	Value in Rs.
	TOTAL VALUE IN RS.				
	Packing & Forwarding charges in % if any				
	Freight & Insurance Charges In % if freight charges are not mentioned it will be considered as FOR-BHEL TRICHY.				
	Excise Duty (indicate in %)				
	A) TNGST — VAT (%)				
	B) CST with C-FORM — (%)				
	C) CST without C-Form — (%)				
	Approximate Net weight of the total consignment				
	Approximate Gross weight of the total consignment				
	Approximate Dimensions of the Consignment				
	The price indicated shall be inclusive of all accessories, spares etc. as given in the scope of supply. Individual item-wise break-up price shall be attached as an annexure to this price bid format.				

Signature & Seal of Vendor

NOTE:

- 1. The price bid should be submitted only as per the above format. No row shall be left blank. Please indicate NA, in case the item is "not applicable"**
- 2. Prices shall be quoted item-wise only as per the above format.**
- 3. If Price quoted is Inclusive of ED, the included ED Value and Base Value shall be indicated item-wise.**

Payment Term (Indigenous)	
If materials are receivable at Stores/Trichy without PBG	Payment term is 100% direct payment after 45 days from the date of receipt and acceptance of materials.
If materials are receivable at Stores/Trichy with PBG	Payment term is 100% direct payment after 45 days from the date of receipt and acceptance of materials and against 10% PBG valid for the warranty period.
Any deviation in the above payment term will attract loading as mentioned below. “Base rate of SBI (as applicable on the date of bid opening. Techno-commercial bid opening in case of two part bids) + 6% shall be considered for loading for the period of relaxation sought by bidders.	

Payment through Bank is not preferred. In case of Payment through Bank is opted by Supplier, BHEL prefers documents submission through bank with copy of LR and door delivery of Goods to Site/Stores with Consignee copy attached. In this case Loading will be 3% on the offered value.

Offers of indigenous Suppliers with payment terms as LC/Advance Payment are liable for rejection.

Liquidated Damages / Penalty -

Liquidated damages shall be 0.5% of the total order value per week or part thereof subject to a maximum of 10% of the total order value.

For staggered delivery schedule, LD shall be 0.5% of the undelivered portion per week of the delay or part thereof subject to a maximum of 10% of the total order value.

Any deviation from the above LD clause, loading will be applied to the extent to which it is not agreed by the bidder (at offered value).

Guarantee / Warranty Period – (if applicable)

Normally No deviation permitted and the deviated offers are liable for rejection.

Ranking-

BHEL will consider the ranking after the loading is applied as referred above wherever deviations are observed.

Performance Bank Guarantee – (if applicable)

Normally No deviation permitted and the deviated offers are liable for rejection.

NOTE:-

1. If the due date of tender opening happens to be a holiday, the tenders will be opened on the next working day.
2. BHEL reserves the right to go for a reverse auction (RA) instead of opening the submitted sealed bid which will be decided after technical evaluation. Information and general terms and conditions covering RA are given in commercial terms and conditions.
3. Corrigendum if any, with respect to this tender will be hosted only in the website <http://www.bhel.com> or <http://tenders.gov.in>. You are requested to visit the website regularly for updates.

Special Provisions for Micro and Small Enterprises (MSE)

1. 20% of the tendered quantity is earmarked for MSE suppliers in this tender.
2. Out of the 20% tendered quantity reserved for MSE suppliers, 4% shall be earmarked for procurement from MSE owned by SC/ST entrepreneurs.
3. Incase MSE vendor participating in the tender quotes within the price band of L1+15%, they will be allowed to supply the portion of the requirement subject to acceptance of L1 price by MSE vendor. In case of more than one such MSE, the supply shall be shared proportionately.
4. "MSE suppliers can avail the intended benefits only if they submit along with the offer, attested copies of either EM II certificate having deemed validity (five years from the date of issue of acknowledgement in EM-II) or valid NSIC certificate or EM II certificate along with attested copy of a CA certificate (Format enclosed at Annexure -VII where deemed validity of EM II certificate of five Years has expired) applicable for the relevant financial year (latest audited). Date to be reckoned for determining the deemed validity will be the date of bid opening (Part I in case of two part bid). Non submission of such documents will lead to consideration of their bid at par with other bidders. No benefit shall be applicable for this enquiry if any deficiency in the above required documents are not submitted before price bid opening. If the tender is to be submitted through e-procurement portal, then the above required documents are to be uploaded on the portal. Documents should be notarized or attested by a Gazetted officer."

Certificate by Chartered Accountant on letter head

This is to Certify that M/S
(hereinafter referred to as 'company') having its registered office at
is registered under MSMED Act 2006, (Entrepreneur
Memorandum No (Part-II) dtd:.....,
Category: (Micro/Small)). (Copy enclosed).

Further verified from the Books of Accounts that the investment of the company as on
date..... as per MSMED Act 2006 is as follows:

1. **For Manufacturing Enterprises:** Investment in plant and machinery (i.e. original cost
excluding land and building and the items specified by the Ministry of Small Scale Industries vide its
notification No.S.O.1722(E) dated October 5, 2006 :
Rs.....Lacs
2. **For Service Enterprises:** Investment in equipment (original cost excluding land and building and
furniture, fittings and other items not directly related to the service rendered or as may be notified under the MSMED
Act, 2006:
Rs.....Lacs

The above Investment of Rs.....Lacs is within permissible limit of
Rs.....Lacs forMicro / Small (Strike off which is not applicable)
Category under MSMED Act 2006.

Date:

(Signature)

Name -

Membership number -

Seal of Chartered Accountant