

 BHEL S40-003/D	BHARAT HEAVY ELECTRICALS LIMITED (A GOVERNMENT OF INDIA UNDERTAKING) SEAMLESS STEEL TUBE PLANT TIRUCHIRAPALLI - 620 014. TAMILNADU (INDIA)	PHONE : 0431-2578480/8491 : 0431-2578406/8419 : 0431-2578568 FAX : 0431-2576828	TIN : 33243560005 Corp. Identity No: L74899DL1964GOI004281	PURCHASE ENQUIRY
		CST. No. : 239383 Dated : 11.06.1991		

VENDOR CODE 22002	ENQUIRY NUMBER 9440673E	ENQUIRY DATE 20/06/2014	ENQUIRY DUE DATE 11/07/2014	No. OF ITEMS 01
-----------------------------	-----------------------------------	-----------------------------------	---------------------------------------	---------------------------

Office Copy

IMPORTANT POINTS :

1. Tender Closing Time : 14.00 Hrs.
2. Tender Opening Time : 15.00 Hrs.
3. Tender should be submitted in a sealed cover, duly indicating enquiry No. Enquiry date & Enquiry Due Date on the cover.
4. Offer(s) received through Courier Services after 14.00 Hrs. on Enquiry Due Date will not be considered.
5. Late Tender(s) is/are liable for rejection.
6. Offer(s) shall be valid for 60 days from Enquiry Due Date.
7. Offer(s) in Vendor's Letter head shall contain.
 - a. Offer No. and Date
 - b. Delivery Period
 - c. Delivery Terms
 - d. Payment Terms
 - e. Excise Duty with Tariff Heading Sales Tax (against form-XVII/Form-C). etc.
 - f. Excise Regn. No. and SSI Regn. No.

Kindly arrange to submit your COMPETITIVE OFFER for the following item(s)
 If you are not in a position to submit your Offer, kindly arrange to send your REGRET LETTER.

THIS IS ONLY A REQUEST FOR OFFER AND NOT AN ORDER

Sl.No.	BHEL Material Code and Description	Unit	Requirement	
			Quantity	Delivery
01	BHEL Material Code : SP9112799003 ----- PISTON SEAL DRG.NO. 3-7-1127-30-01786 4-7-1127-30-00584 MATL.RUBBER WITH FABRIC REINFORCE.	Set	01 2.000	01/09/2014
	Foot Note :: ----- THIS TENDER IS CALLED ON TWO BID SYSTEM.KINDLY REFER THE ANNEXURE-A B & C ATTACHED. CONFIRM THE FOLLOWING COMMERCIAL POINTS WITHOUT FAIL: ----- 1.OUR STD PAYMENT TERMS IS 100 % PYT WITH IN 45 DAYS ON RECEIPT AND ACCEPTANCE OF MATERIALS THRO E-PAYMENT.FORMAT WILL BE SENT ALONG WITH PUR ORDER. 2.PL QUOTE THE RATE ON DOOR DELIVERY BASIS DULY INCLUDING PKG,FORWARDING, FREIGHT AND INSURANCE CHARGES. 3.TEST AND GUARANTEE CERTIFICATES ARE TO BE SUBMITTED ALONG WITH SUPPLIES. 4.CONFIRM YR ACCEPTANCE FOR LD AND RISK PURCHASE CLAUSES.			

IMPORTANT NOTE :

- 1. Delivery Terms : "Free Delivery at BHEL-SSTP STORES" is preferable.
- 2. Payment Terms : 100% payment after 45 days after receipt and acceptance of materials by BHEL.
- 3. Terms and Conditions of Tender : Please see reverse.
- 4. The Technical Requirements/Specification Details/Quality Requirements/Commercial Terms & Conditions are clearly furnished in the Tender. If Deviation(s) is/are not explicitly brought out in the Offer, it will be construed that the Tenderer is complying with the requirement of BHEL in full without any deviation(s).

For and on behalf of
BHARAT HEAVY ELECTRICALS LTD.



PURCHASE EXECUTIVE

REGISTERED OFFICE : BHEL HOUSE, SIRI FORT, NEW DELHI - 110 049.

TERMS AND CONDITIONS OF ENQUIRY

01. **OFFER**
 01. Each Tender shall be sent in double cover. Inner cover shall be sealed with Tenderer's distinctive seal and superscribed with correct Enquiry No. and Enquiry Due Date. The Outer cover shall only bear the address of this Office and shall not have any indication that a Tender is within. more Offers shall not be sent in one cover but the Offer against each Enquiry shall be sent separately to avoid confusion. Tender shall be addressed to any individual's name but only by Designation.
 02. Tenders shall be free from CORRECTION AND ERASURES. Corrections, if any, must be attested. All amounts shall be indicated both in words and in figures. Where there is difference between the amount quoted in words and figures, amount quoted in words shall prevail.
 03. Rate(s) shall be net F.O.R./BHEL-SSTP STORES, inclusive of risk-in-transit and remain valid for 60 days from the Enquiry Due Date/other Taxes/Duties.
 04. If any Sales Tax and/or Excise Duty and/or other Taxes/Duties is/are payable as extra to the quoted Rate, it shall be specifically stated in offer, failing which the Purchaser will not be liable for payment of Sales/Excise Duty/other Taxes/Duties.
 05. No voluntary revision of prices will be entertained after opening the Tender(s).
 06. Manufacturer's Name, Trade Mark or Patent No., if any, shall be specified. Illustrative leaflets giving technical particulars are required along with the tender wherever necessary.
 07. Products with I.S.I. Certification Marks will be preferred.
 08. The Purchaser shall be under no obligation to accept the Lowest Tender or any other Tender. The Purchaser shall be entitled to accept or reject any Tender in part or full, without assigning any reason whatsoever.
 09. The Purchaser also reserves the right to allow the Purchase Preference Facilities to the Public Enterprises, as admissible under Government Policy. Amendments thereto from time to time.
 10. BHEL reserves the right to increase or decrease the Tender Quantity and split the Tender Quantity among more than one Tenderer and place the order accordingly in proportion, based on commitment, requirement and Supplier's capability in terms of delivery and quality.
 11. Lowest Rate received against Tender(s) need not be the technically acceptable L-1 Rate and BHEL reserves the right not to consider the same.
 12. BHEL reserves the right to negotiate or re-float the opened Tender, if L-1 Rate is not the lowest acceptable rate to them, inter-alia other reasons.
 13. BHEL reserves the right to negotiate the L-1 rate.
 14. BHEL may order on more than one Vendor at the lowest acceptable Rate.
02. **SAMPLES**: Wherever possible, samples shall be submitted separately whether specifically requested or not, so as to reach the Purchaser on or before the Enquiry Due Date. They shall be clearly marked with the Enquiry No. and Enquiry Date, on the cover to facilitate identification.
03. **PACKING AND MARKING**: The Seller shall arrange for securely protecting and packing the stores to avoid loss or damage during transit.
04. **TERMS OF PAYMENT**: 100% Payment will be made after 45 days of receipt and acceptance of materials at BHEL. Wherever required by the Purchaser, the successful Tenderer shall send the operation and maintenance Manual(s), Test Certificate(s), Drawing(s) etc., for the materials ordered, along with the materials and statement to that effect to be made in the invoice. Failure to comply with this provision, will result in delay in payment of the bill(s). Goods despatched either by V.P.P. or routing the documents to the Bank, will not be accepted unless agreed to by the Purchaser.
05. **SECURITY DEPOSIT**: For Purchase over Rs. 5000.00 the successful Tenderer or may be required to furnish a Bank Guarantee/Security Deposit for an appropriate value determined by BHEL, through any of the Nationalised Bank/Scheduled Banks, who is a member-Bank in BHEL's consortium of Banks, which will be intimated along with Purchase Order, at the discretion of BHEL.
06. **LIQUIDATED DAMAGES**: It is clearly understood among the parties to the contract that TIME IS THE ESSENCE OF THE CONTRACT. Therefore the delivery of the goods specified in the Purchase order shall be made within the time prescribed. Where the seller supplies or despatches the goods. Beyond the delivery period specified, and the Purchaser will have no obligation to accept the goods. If accepted, Liquidated Damages at the rate of 0.5% (zero point five percent) of the value of goods delayed, per week or part thereof, subject to a maximum of 10% (Ten percent) or part thereof, will be levied without prejudice to any other relief or compensation due to the Purchaser under any conditions of the contract.
07. **RISK PURCHASE**: Alternatively, the Purchaser, at his option, will be entitled to terminate the Contract and to purchase elsewhere at the risk and cost of Seller, the whole of the goods or any part, which the Seller has failed to deliver or despatch within the time stipulated as aforesaid or if the same were not available, the best and nearest available substitute thereof. The Seller shall be liable for any loss, which the Purchaser may sustain by reason of such termination. Purchase(s), in addition to penalty at the rate mentioned in Clause No. 06 above.
08. **PREFERENTIAL DELIVERY**: In case of failure to complete supplies, in terms of such Contract within the date of delivery specified in the Tender and incorporated in the Contract, it shall be noted that in the event of an Order is placed on a higher Tenderer as result of this invitation of Tender, in preference to the lowest acceptable Offer in consideration of the earlier delivery, the Seller will be liable to pay to the Purchaser the difference between the Contract Rate and the lowest acceptable Tender on the basis of final price. (F.O.R./BHEL-SSTP Stores) including all elements of Freight, Sales Tax, Duty(s) and other incidentals.
09. **GUARANTEE**:
 01. In the event of an Order, the materials notified in the Order shall be guaranteed for satisfactory performance against all manufacturing defects, faulty design and bad workmanship, etc. The liability under Seller's Guarantee Certificate shall cover a total period of 18 (Eighteen) Months from the date of despatch of the materials. 12 (Twelve) Months from the date of actual usage of the material(s) whichever is earlier. A Guarantee Certificate to the above effect shall accompany the despatch documents. In case of staggered delivery, the Guarantee Certificate shall accompany the despatch documents each time.
 02. **Performance Bank Guarantee**: Wherever required, BHEL shall request the successful Tenderer to execute a Performance Bank Guarantee, covering the standard Guarantee Terms of BHEL, through any of the Nationalised Banks / Scheduled Banks, who is a Member-Bank in BHEL's Consortium of Banks, which will be intimated along with Purchase Order, at the discretion of BHEL.
10. **CENVAT CREDIT**:
 01. Please explicitly indicate the following in the Offer to enable us to avail CENVAT Credit.
 01. Excise Registration Number, Excise Control Code (ECC) Number,
 02. Central Excise Chapter Heading Number, Under which the goods will be cleared,
 03. Present Rate of Excise Duty.
 02. In the event of an Order being placed, Excise Duty will be reimbursed only based on the Duplicate Copy EXCISE INVOICE (Transporter's Copy), Seller shall take acknowledgement from the authorised personnel/transporter, while delivering the goods, for having handed over the above Duplicate Copy.
 03. If the Seller is a First Stage Dealer / Second Stage Dealer / Depot / Consignment Agent / Importer / Importer-Agent, the Seller has to confirm that they will be following the procedures in terms of the provisions of Central Excise Rules-2002, to enable BHEL to avail CENVAT Credit, under CENVAT Credit Rules-2002.
 04. All the time of submission of invoice(s), the Seller is required to furnish the following Certificate:

"The Amount of Rs. (Rupees in words.....) claimed as CENVAT in the Bill, is in accordance with the provisions of the Rules in all respects and that the same has been paid to the Central Excise Authorities in respect of the materials covered by the Bill".
11. **GENERAL**: Any other conditions which might have been quoted by the Seller and are in contravention to the Terms prescribed in the Tender/Order and which have not been specifically accepted by the Purchaser, will not be applicable to the Contract and BHEL's standard Terms & Conditions shall only be applicable.
12. **IMPORTANT NOTE**:
 01. Purchaser reserves the right to place Repeat Order(s) at the same Price and Terms & Condition, within 36 (Thirty Six Months) from the date of completion of supply, whichever is earlier. A specific confirmation in the regard shall only be applicable.
 02. In the event of quoting "Packing and Forwarding charges" extra in the offer, the "Packing Charges" and "Forwarding Charges" shall be separately quoted and shall not be combined. Also please note that no Excise Duty and sales Tax shall be payable on Forwarding Charges. In case this is not complied with corresponding Excise Duty and Sales Tax on packing Charges will not be paid.
 03. In the event of the Tenderer being a S.S.I. Unit, the tenderer shall indicate the S.S.I. Regn. No. in the Offer and also enclose a copy of S.S.I. Registration Certificate issued by the Competent Authority.
 04. Tenderer is requested to furnish all the details called for in the Tender. In case any required data/information is/ are not furnished in the offer, Purchaser reserves the right to assume the same for the purpose of evaluation/comparison and decide the Tender accordingly.

FIRST ANGLE PROJECTION (ALL DIMENSIONS IN MILLIMETRES)

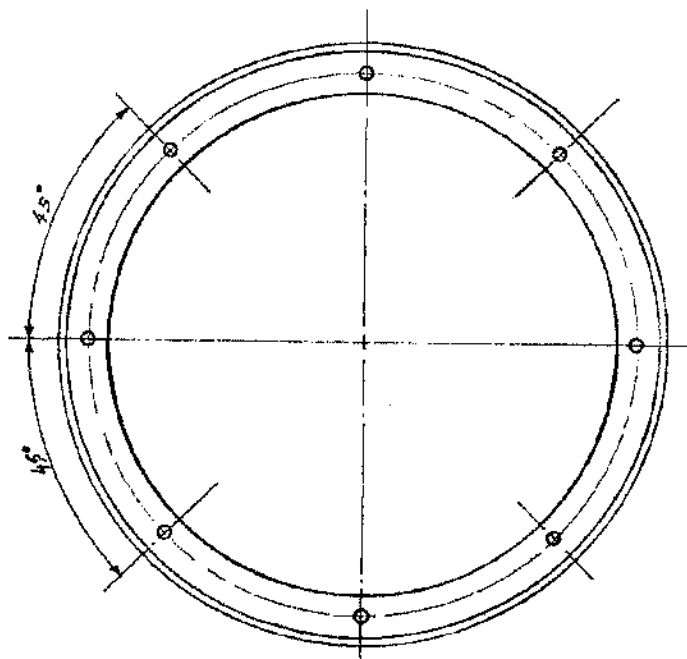
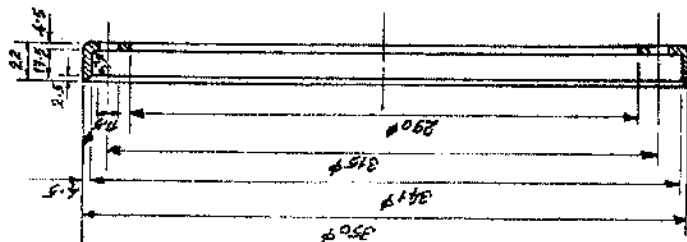

MATL: Rubber with Fabric Reinforce

ITEM NO.	DESCRIPTION	DRAWING NO.	MATL CODE	UNIT WT	QTY						
5871	PUSH BENCH.										
<table border="1"> <tr> <td>DATE</td> <td>SIGN</td> <td>NO.</td> </tr> <tr> <td>22/03/24</td> <td>8/03/24</td> <td>22/03/24</td> </tr> </table>						DATE	SIGN	NO.	22/03/24	8/03/24	22/03/24
DATE	SIGN	NO.									
22/03/24	8/03/24	22/03/24									
<table border="1"> <tr> <td>NAME</td> <td>DATE</td> <td>NO.</td> </tr> <tr> <td>SHARAT HEAVY ELECTRICALS LTD.</td> <td>22/03/24</td> <td>22/03/24</td> </tr> </table>						NAME	DATE	NO.	SHARAT HEAVY ELECTRICALS LTD.	22/03/24	22/03/24
NAME	DATE	NO.									
SHARAT HEAVY ELECTRICALS LTD.	22/03/24	22/03/24									
<table border="1"> <tr> <td>SEAMLESS STEEL TUBE PLANT</td> <td>WEIGHT (KG)</td> <td>REF TO ASS'GLED ORG</td> </tr> <tr> <td>TIRUCHIRAPALLI-820014</td> <td>1.25</td> <td>RW 28619</td> </tr> </table>						SEAMLESS STEEL TUBE PLANT	WEIGHT (KG)	REF TO ASS'GLED ORG	TIRUCHIRAPALLI-820014	1.25	RW 28619
SEAMLESS STEEL TUBE PLANT	WEIGHT (KG)	REF TO ASS'GLED ORG									
TIRUCHIRAPALLI-820014	1.25	RW 28619									
<table border="1"> <tr> <td>SCALE</td> <td>1:25</td> </tr> </table>						SCALE	1:25				
SCALE	1:25										
<table border="1"> <tr> <td>DEPT</td> <td>ALTERED</td> <td>CHECKED</td> </tr> <tr> <td>CODE</td> <td>DATE</td> <td>20/03/24</td> </tr> </table>						DEPT	ALTERED	CHECKED	CODE	DATE	20/03/24
DEPT	ALTERED	CHECKED									
CODE	DATE	20/03/24									
<table border="1"> <tr> <td>TITLE</td> <td>SEAL</td> </tr> </table>						TITLE	SEAL				
TITLE	SEAL										
<table border="1"> <tr> <td>CARD CODE</td> <td>U 01</td> </tr> </table>						CARD CODE	U 01				
CARD CODE	U 01										
<table border="1"> <tr> <td>DRAWING NO.</td> <td>3-7-112730-01786</td> </tr> </table>						DRAWING NO.	3-7-112730-01786				
DRAWING NO.	3-7-112730-01786										

CAUTION THE INFORMATION ON THIS DOCUMENT IS THE PROPERTY OF SHARAT HEAVY ELECTRICALS LTD. IT MUST NOT BE USED OR REPRODUCED IN ANY MANNER WITHOUT THE WRITTEN PERMISSION OF THE COMPANY.

CAUTION THE INFORMATION ON THIS DOCUMENT IS THE PROPERTY OF BHARAT HEAVY ELECTRICALS LTD. IT MUST NOT BE USED DIRECTLY OR INDIRECTLY IN ANY WAY DETRIMENTAL TO THE INTEREST OF THE COMPANY.

FIRST ANGLE PROJECTION (ALL DIMENSIONS IN MILLIMETRES)

REV	DATE	ALTERED
01		CHECKED
2008		

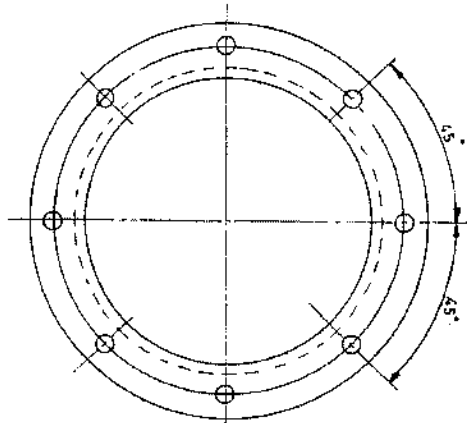
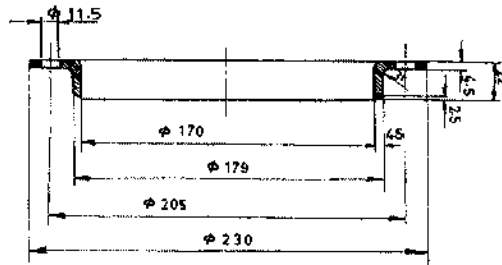

MATL: Rubber with fabric Reinforce

ITEM NO.	DESCRIPTION	MATL CODE	UNIT WT
		MATL SPEC	QTY

EQUIP. PUSH BENCH



Bharat Heavy Electricals Ltd.
SEAMLESS STEEL TUBE PLANT
TRUCHIRAPPALLI-828 014

CHK	APPD	NAME	SIGN	DATE

DEPT	DRWING NO.	SCALE	REVISION NO.	REF TO ESTD/OLD DRWG
CODE	C/M/F	1:2/5		RW28619/5

TITLE	CARD CODE	DRAWING NO.	REL
SEALING RING (PRESSURE OIL JACK ASSY)	U 01	4-7-1127-30-00584	00